

Fast Wireless Charger

Model: IICQI06

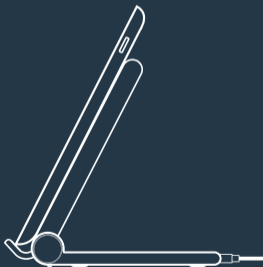

Instruction Manual

iiglo[®]

Specification

Input: DC5V 2A DC9V 1.67A

Frequency: 110~205KHz

Size: 66*117*18mm

Charging Efficiency: $\geq 72\%$

Charging Distance: $\leq 10\text{mm}$

N.W.: 125g

Built-in 2 coils to make sure larger high-efficiency charging position.

LED light clearly show the standby and charging condition.

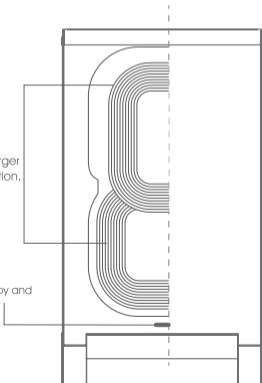

Connect to Power Adapter

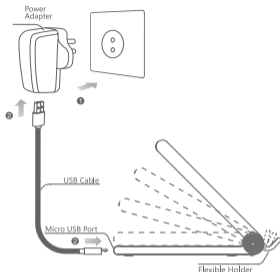

- ① Connect the power adapter to socket.
- ② Connect the adapter to the USB 2.0 interface, the other Micro USB to pad.
- ③ Charging pad indicator light keeps green after two seconds and enter to standby mode.

* There are spindles inside the charging stand, offering many kinds of charging angle according to your use. it's controlled by smart chipset, no worry about the long standby.

* This product universally support two modes of wireless charging

1. Fast Wireless Charging (output 10W)

It works with device which support fast wireless charging, such as Samsung Galaxy S6 Edge +, Galaxy Note5, Galaxy S7, Galaxy S7 Edge, Galaxy S8, Galaxy S8+.

2. Standard Wireless Charging (output 5W)

It works with device which only support standard wireless charging, Such as Samsung Galaxy S6, S6 Edge and other Qi-enabled devices.

* Only Qualcomm quick charge adapter or Samsung original fast charge adapter support this product's fast wireless charging function, you need to buy it separately.

Charging Mode

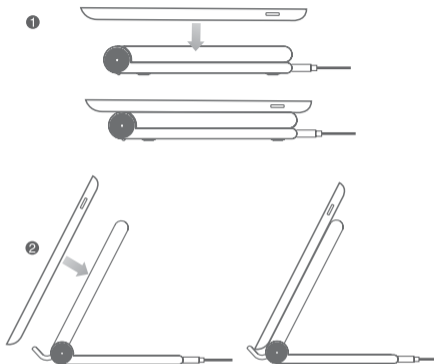

- ① Make sure the charging pad is connected to the power supply, the indicator light is green and the charger is in standby mode.
- ② Put the wireless charging smartphone on the charging pad, the indicator light turns off, the charger enters into charging mode.
- ③ Remove the receiver(wireless charging smartphone), the indicator light turns green, the charger enters into standby mode.

* When Samsung phones which are built-in wireless charging function get fully charged with this product, if don't move the phone in a long time, the battery power keeps in fully charged status(supplementary charge).

Notes

1. Do not squeeze or subject to any kind of shock or knocking.
2. Do not disassemble or throw into fire or water, to avoid causing a short circuit leakage.
3. Do not use wireless charger in severely hot, humid or corrosive environments, to avoid circuit damage and occurs leakage phenomnon.
4. Do not place too close with magnetic stripe or chip card (ID card, bank cards, etc.) to avoid magnetic failure.
5. Please keep the distance at least 20cm between implantable medical devices (pacemakers, implantable cochlear, etc.) and the wireless charger, to avoid potential interference with the medical device.
6. To take care of the children, to ensure that they won't play the wireless charger as a toy, to avoid unnecessary accidents.

Imported by iiglo

Østre Kullerød 4, N-3241 Sandefjord, Norway

www.iiglo.com | Made in China